

DELHI IMPROVEMENT TRUST LAY-OUT PLAN OF BAGH AMBA AND SARAI ROHILLA TOWN EXP. SCHEME

SCALE 100 FT TO AN INCH.

- REFERENCES:-
- (1) TOTAL NO OF PLOTS IN BAGH AMBA = 89 Nos
 - (2) TOTAL NO OF PLOTS IN BAGH MURID KHAN = 124 PLOTS
 - (3) EXISTING BUILDING SHOWN HATCHED THUS
 - (4) SIZE OF PLOT = 37.6' x 22.5' = 81.6 SQ YDS. EACH
 - (5) PUMP SIDE SHOWN THUS
 - (6) PUBLIC LATRINES SHOWN THUS EACH UNIT OF 12 SEATS

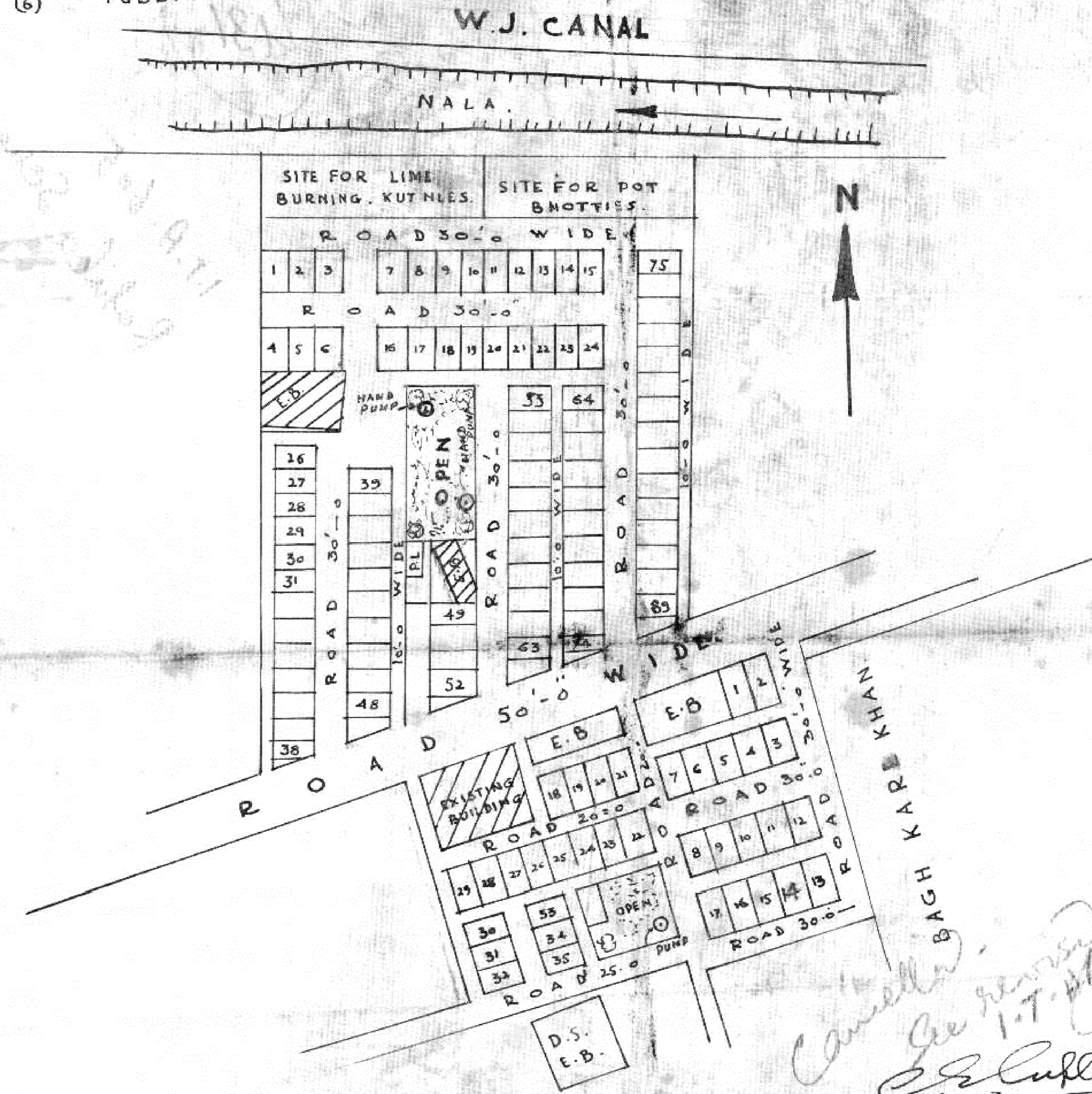

Bakshi Jag Mohan
TRACED BY *D.G.* 4-10-55
D.I.T.

Cancelled
See plan
1.7.1954
A.R. I. B. A. I. I. A.

A.R. I. B. A. I. I. A.
ARCHITECT
DELHI IMPROVEMENT
I.T.A. 605. TRUST.